



663170 Sizzix® Thinlits™ Die Set - Angel, 3-D by Jen Long



1. Die-cut the Angel out of desired material.



2. Curl the body into a cone shape.

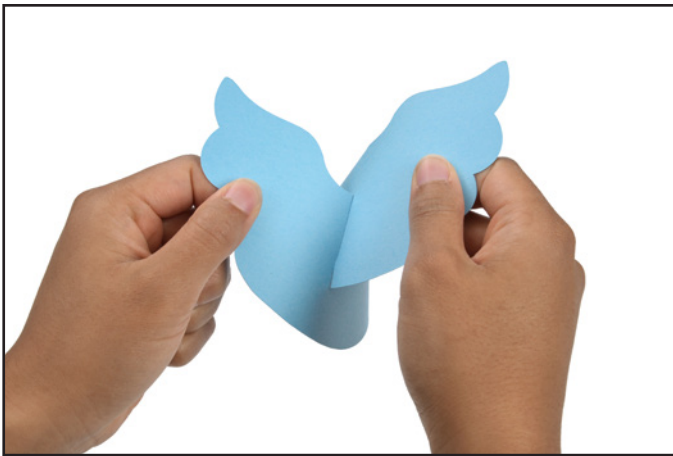

3. Interlock the wings by sliding the slit at the top of one wing into the slit at the bottom of the other wing.



4. Use a piece of tape to hold the inside of the cone in position, and embellish as desired.