

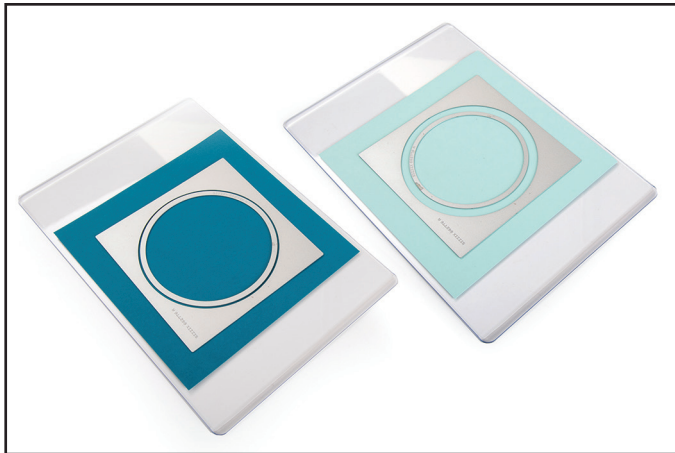

662776 Sizzix® Thinlits™ Die Set - Shadow Box, Mini by Katelyn Lizardi



1. Die-cut two front panels out of contrasting colors. Die-cut one using the large circular insert and the other using the small circular insert.



2. Die-cut the back, top and bottom and any desired embellishments.

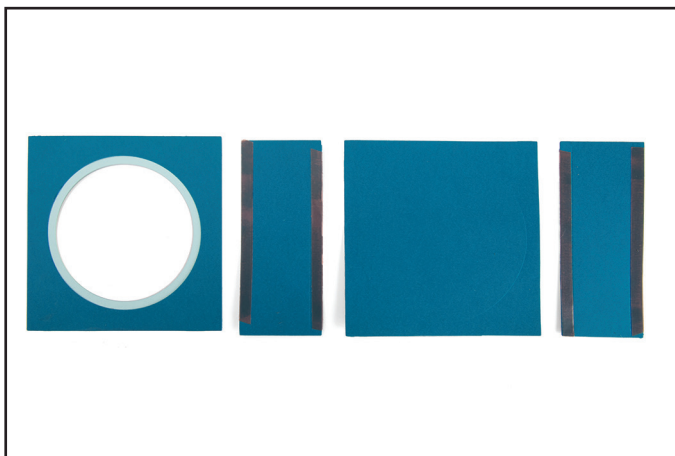

3. Adhere the front panel with the small cutout behind the panel with the large cutout to create a frame effect. Apply adhesive to both tabs on the top and bottom pieces.

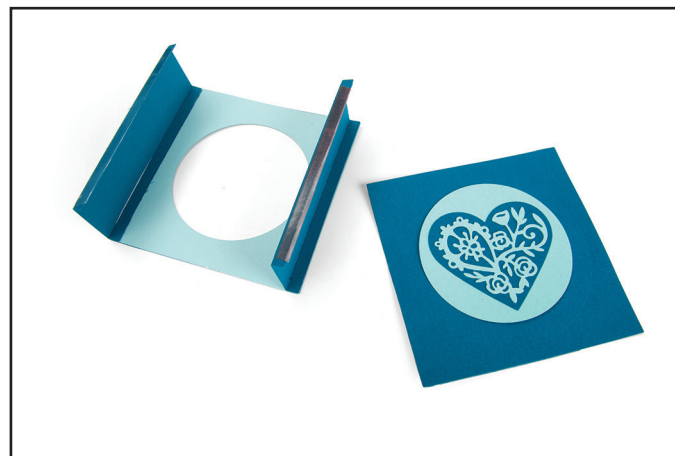

4. Adhere the top and bottom to the back of the front. Embellish the back of the shadow box before adhering it to the top and bottom.



5. Attach the back, and embellish the outside of the shadow box as desired.